

**Key**

- ① Existing substrate/timber deck prepared in strict accordance with Sika Liquid Plastics Project Specification
- ② ——— Decothane Base Coat with embedded Reemat Premium GFM
- ③ Tanalised timber battens installed at centres over the roof to suit the clients aesthetic requirements; ensure cross-falls are not compromised. Bond timber battens to the cured, fully reinforced Decothane Base Coat using Decostik adhesive and/or mechanically fix at 300mm c/c's as required
- ④ ——— Sika Quick Cure Primer applied to exposed, clean and prepared timber surfaces; allow to dry
- ⑤ ——— Localised application of Decothane Base Coat @ 1.0l/m<sup>2</sup> with embedded Reemat Premium GFM applied over the timber roll battens to overlap with the first Decothane Base Coat application by a minimum 50mm
- ⑥ ——— Decothane Top Coat as per Sika Liquid Plastics Project Specification

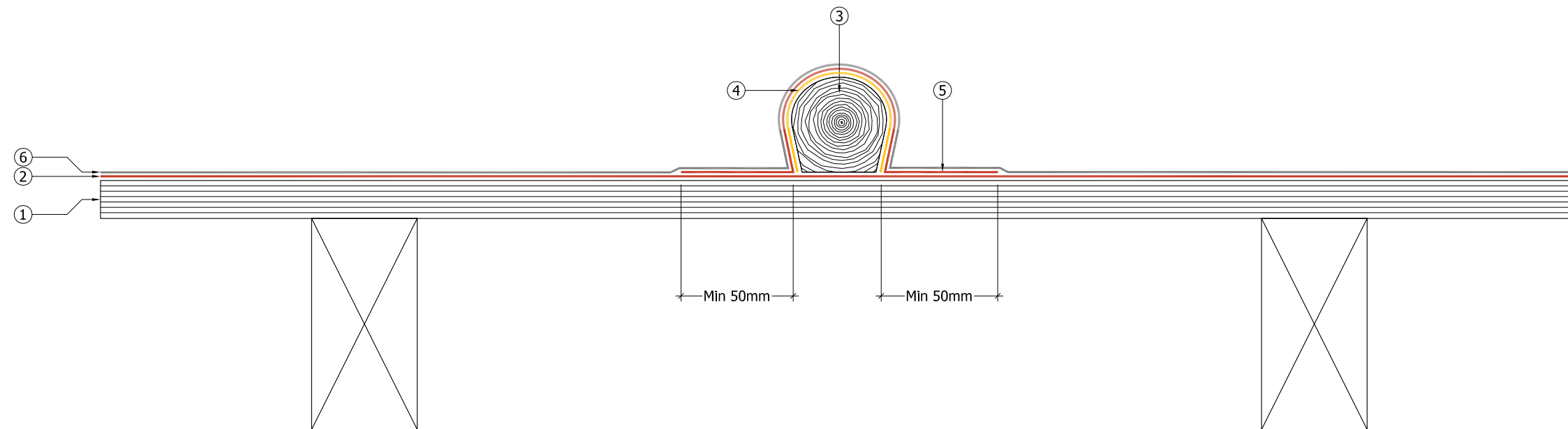

Sika Liquid Plastics  
 Sika House  
 Miller Street  
 Preston  
 Lancashire PR1 1EA  
 Telephone: 01772 259781  
 Email: [technical.customer.services@uk.sika.com](mailto:technical.customer.services@uk.sika.com)  
 Web: [www.liquidplastics.co.uk](http://www.liquidplastics.co.uk)

This drawing is solely intended to illustrate the correct application of Sika Liquid Plastics products and systems. It must be read in conjunction with the appropriate specification and current issue of relevant Product Data Sheets. All elements bearing reference to structural and/or thermal design are shown indicatively and **should not be used** in whole or in part for any aspect of project design without consulting the relevant authorities.

For refurbishment projects, all aspects of the existing roof are deemed to be fully compliant with BS 6229:2003 [Code of Practice for Flat Roofs with Continuously Supported Coverings] or improved upon for instances where these standards are not met.

Site-specific details not covered by our standard range can be obtained by providing relevant information to the email address shown.

Project No

DWG No Revision

Project:

Drawing Title:  
 Waterproofing Sequencing Build-Up  
 and application detail to an imitation  
 timber core roof roll

Scale: NTS @ A3 Drawn:

Date:

